

T0-24603-000
SHT 1.1

NOTES:

1. INCREASED PRESSURE AT THE SOUND INLET CAUSES A POSITIVE GOING VOLTAGE TO APPEAR AT THE OUTPUT TERMINAL, RELATIVE TO THE NEGATIVE TERMINAL.

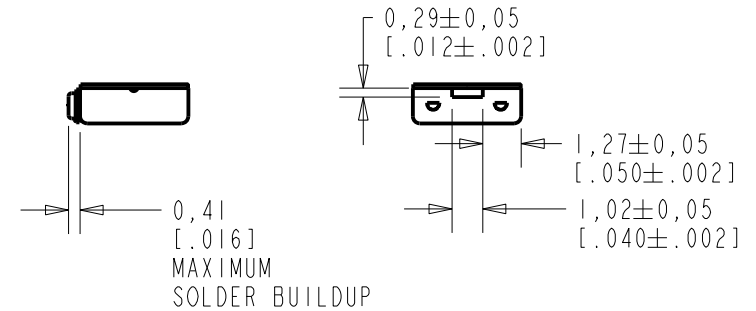
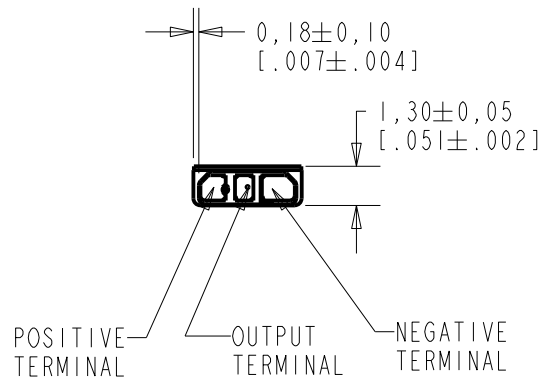
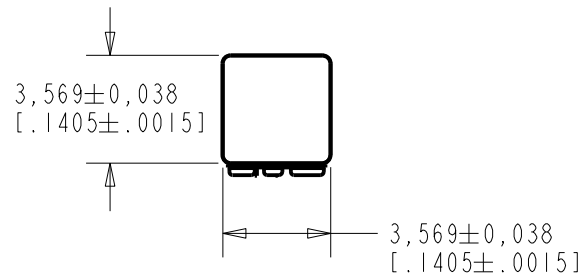

NOMINAL WEIGHT
.063 GRAMS

DIMENSIONS IN MILLIMETERS [INCHES]

| Revision | C.O. # | Implementation Date | RELEASE LEVEL | REVISION |
|----------|-----------|---------------------|---------------|----------|
| F | MI0105050 | 5-21-13 | Active | F |
| E | MI0104288 | 8-18-11 | | |
| D | MI0103810 | 8-23-10 | | |

| | | | |
|----------------------|--|---------|---------|
| SCALE: 4:1 | | DR. BY | DATE |
| DO NOT SCALE DRAWING | | MMM | 2-9-06 |
| TITLE: MICROPHONE | | CK. BY | DATE |
| OUTLINE DRAWING | | GJP | 2-10-06 |
| T0-24603-000 | | APP. BY | DATE |
| SHT 1.1 | | GJP | 2-10-06 |

KNOWLES ELECTRONICS
ITASCA, ILLINOIS U.S.A.

SENSITIVITY IN dB RELATIVE TO 1.0 VOLT/0.1 Pa (N/M²)
FOR CONDITIONS SHOWN BELOW.

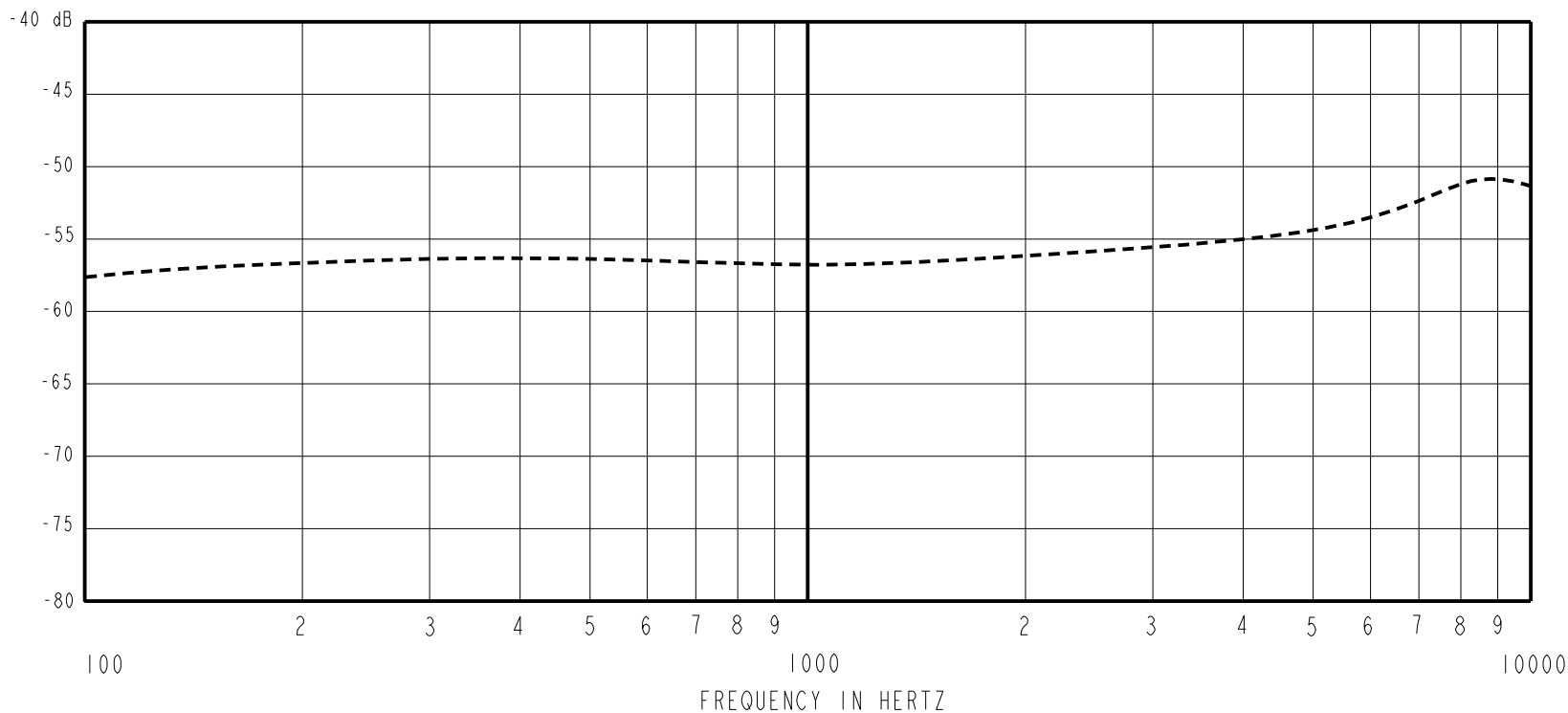

| FREQUENCY | SENSITIVITY | | | DEVICE CONFORMITY | |
|-----------|-------------|-------|-------|------------------------------|------|
| | MIN. | NOM. | MAX. | RANGE OF DEVIATION FROM 1KHz | |
| 100 | --- | -58.0 | --- | -4.5 | 0.0 |
| 1000 | -59.5 | -56.5 | -53.5 | 0.0 | 0.0 |
| ~9500 | --- | -51.5 | --- | +2.0 | +8.0 |

- NOTES:
1. CASE CONNECTED TO NEGATIVE TERMINAL.
 2. MICROPHONE TO BE FUNCTIONAL WITH 1.6 VDC SUPPLY.
 3. TYPICAL SENSITIVITY TO HUMIDITY AT 1000Hz IS 0.03 dB/%RH
 4. SENSITIVITY AND NOISE VALUES INDICATED ON THIS SPECIFICATION ARE VALID AT 50% HUMIDITY.

| PORT LOCATION | DC SUPPLY | AMPLIFIER CURRENT DRAIN | SENSITIVITY CHANGE ON REDUCING SUPPLY TO 0.9VDC | "A" WEIGHTED NOISE (1 kHz EQUIV. SPL) | OUTPUT IMPEDANCE OHMS | | |
|---------------|-----------|-------------------------|---|---------------------------------------|-----------------------|------|------|
| | | | | | MIN. | NOM. | MAX. |
| 12C | 1.3V | 50 µA MAX. | 3 dB MAX. | 29.0 dB MAX. | 2800 | 4400 | 6800 |

| Revision | C.O. # | Implementation Date | RELEASE LEVEL | REVISION |
|----------|-----------|---------------------|---------------|----------|
| F | M10105050 | 5-21-13 | Active | F |
| E | M10104288 | 8-18-11 | | |
| D | M10103810 | 8-23-10 | | |

KNOWLES ELECTRONICS
ITASCA, ILLINOIS U.S.A.

WHEN TEST LIMITS ARE USED TO ESTABLISH INCOMING INSPECTION ACCEPTANCE/REJECTION CRITERIA, CORRELATION OF TEST EQUIPMENT WITH KNOWLES IS ALSO REQUIRED FOR ELIMINATION OF EQUIPMENT AND TEST METHOD VARIATION

TITLE: **MICROPHONE**
PERFORMANCE SPECIFICATION

TO-24603-000
SHT 2.1

| DR. BY | DATE |
|---------|---------|
| MMM | 2-9-06 |
| CK. BY | DATE |
| GJP | 2-10-06 |
| APP. BY | DATE |
| GJP | 2-10-06 |