

NOTES:

1. INSULATORS: PBTP GF UL 94 V-0, GREY
2. CONTACTS: COPPER ALLOY
PLATING: GOLD OVER NICKEL
50 MATING CYCLES
3. PCB-CLIP: COPPER ALLOY
PCB HOLE $\phi 2.8 \pm 0.1$ / PCB THICKNESS $t = 1.6 \text{mm}$
4. CONNECTOR IS PART MARKED: 121A20849X CONEC ABC

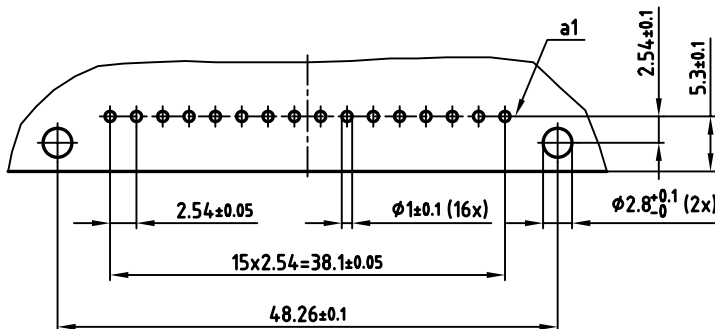

P.C.B. HOLE DRILLINGS



APPROVAL # FREIGABE # DEBLOCAGE # AUTORIZACION # APPROVAL	
CUSTOMER APPROVAL DATE:	
NAME:	TITLE:
COMPANY NAME:	
APPROVAL # FREIGABE # DEBLOCAGE # AUTORIZACION # APPROVAL	

THIS DRAWING MAY NOT BE COPIED OR REPRODUCED IN ANY WAY, AND MAY NOT BE PASSED ON TO A THIRD PARTY, WITHOUT WRITTEN PERMISSION.
OWNERSHIP AND COPYRIGHT OF CONEC Gmbh
DO NOT ALTER CAD DRAWING BY HAND

rev.	description	date	name

tolerance		scale:	2:1
dim. in mm		material:	SEE NOTES
2005	date	name	
drawn	19.12.	Lehmenkühler	
appd.	19.12.	Mickenbecker	
norm	DIN EN 60603		
d-old			
		dwg no:	AutoCAD 2004
			DIN-A
			3
			sh: 1/1

title:	MALE CONNECTOR TYPE "B 1/2"
	16pos. ANGLED
	with clip
dwg no:	12K1A412
part no:	121A20849X