

Customer Information Sheet

DRAWING No.: M20-106XX00

IF IN DOUBT - ASK

Ⓒ

NOT TO SCALE

THIRD ANGLE PROJECTION

ALL DIMENSIONS IN mm

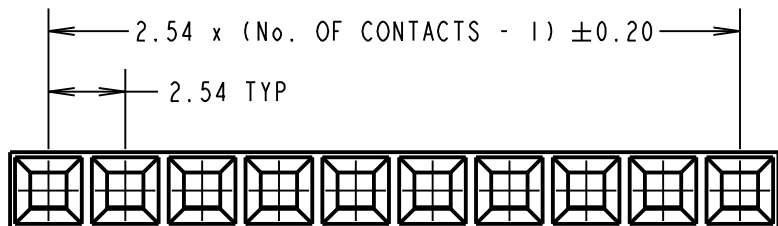

ORDER CODE:

M20-106XX00

No. OF CONTACTS:
01 TO 12

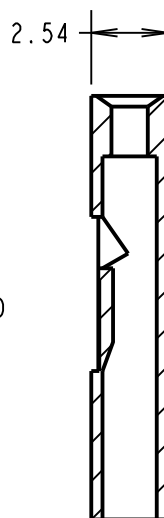
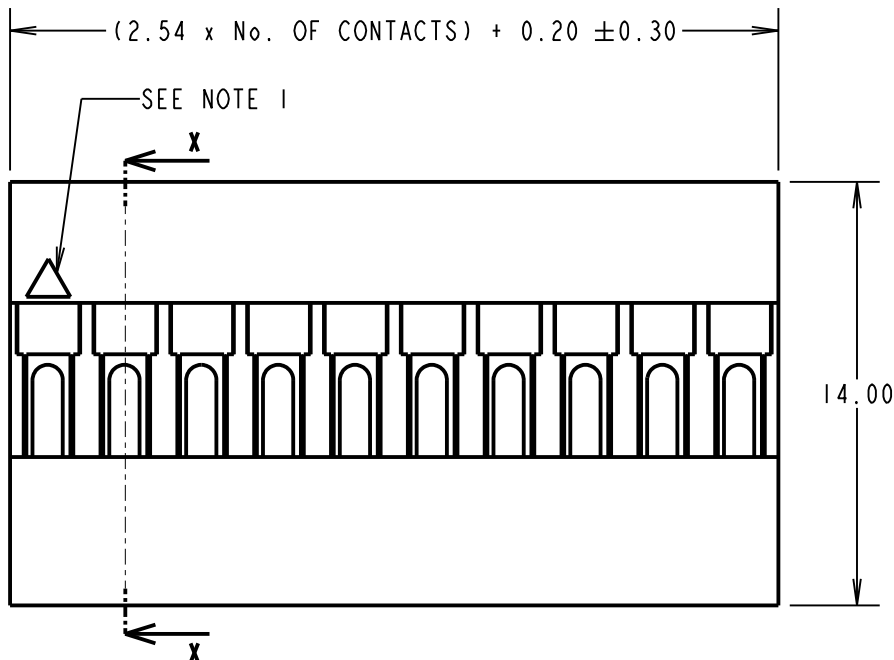

SECTION X-X

SPECIFICATIONS:

ELECTRICAL:

CURRENT RATING = 3A AC/DC

VOLTAGE RATING = 250V AC MAX

CONTACT RESISTANCE = 20mΩ MAX

INSULATION RESISTANCE = 5,000MΩ MIN

DIELECTRIC STRENGTH = 1,500V AC FOR 1 MINUTE

ENVIRONMENTAL:

TEMPERATURE RANGE = -40°C TO +105°C

NOTES:

- CONTACT No. 1 IDENTIFICATION.
- FOR USE WITH CRIMP CONTACTS:
M20-11600XX (RELDED CONTACTS),
M20-11800XX (LOOSE CONTACTS).
- THE ABOVE SPECIFICATIONS APPLY WHEN THIS MOULDING IS USED WITH THE SPECIFIED CONTACTS.
- FOR COMPLETE ELECTRICAL AND MECHANICAL SPECIFICATION, SEE COMPONENT SPECIFICATION COOIXX (LATEST ISSUE).

| | | | |
|----------------|------|-----------|--------|
| SB | 6 | 14.07.14 | 12528 |
| NAME | ISS. | DATE | C/NOTE |
| APPROVED: | | S.BENNETT | |
| CHECKED: | | M.PLESTED | |
| DRAWN: | | S.BENNETT | |
| CUSTOMER REF.: | | | |
| ASSEMBLY DRG: | | | |

HARWIN

www.harwin.com
technical@harwin.com

THIS DRAWING AND ANY INFORMATION OR DESCRIPTIVE MATTER SET OUT HEREON ARE CONFIDENTIAL AND COPYRIGHT PROPERTY OF THE HARWIN GROUP AND MUST NOT BE DISCLOSED, LOANED, COPIED OR USED FOR MANUFACTURING, TENDERING OR FOR ANY OTHER PURPOSE WITHOUT THEIR WRITTEN PERMISSION.

TOLERANCES

X. = ±1mm
X.X = ±0.50mm
X.XX = ±0.10mm
X.XXX = ±0.01mm
ANGLES = ±5°
UNLESS STATED

MATERIAL:

PPE+PS
UL94V-1 BLACK

FINISH: CLEAN, FLASH-FREE

S/AREA: mm²

TITLE:

2.54mm PITCH SIL
CRIMP MOULDING

DRAWING NUMBER:

M20-106XX00

SHT
2 OF 2