

| | |
|--------------|-----------------|
| MODEL NO. | PACKAGING |
| 148-0901-721 | ONE PCS PER BAG |

| REV | ECO | DATE |
|-----|-------------|------------|
| 001 | ECO-17-0003 | 12/18/2017 |
| | | |

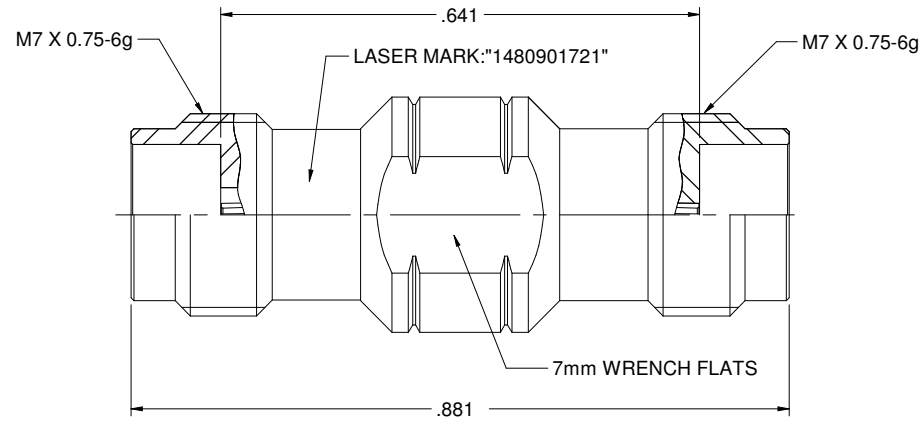

NOTES: UNLESS OTHERWISE SPECIFIED

1. MATERIAL & FINISH:

- 1.1 BODY: PASSIVATED STAINLESS STEEL
- 1.2 CONTACT PIN : GOLD PLATED BERYLLIUM COPPER
- 1.3 INSULATOR: ULTEM 1000 AMBER

2. ELECTRICAL:

- 2.1 IMPEDANCE: 50 OHMS
- 2.2 FREQUENCY RANGE: 0-67 GHZ
- 2.3 VOLTAGE STANDING WAVE RATIO: 1.2 MAX
- 2.4 INSERTION LOSS: 0.05 X/F (GHZ)DB MAX
- 2.5 DIELECTRIC WITHSTANDING VOLTAGE: 500 VRMS MIN
- 2.6 CONTACT RESISTANCE: CENTER CONTACT: 4 MILLIOHMS MAX
OUTER CONTACT: 2.5 MILLIOHMS MAX
- 2.7 INSULATION RESISTANCE: 5000 MOHM MIN

3. MECHANICAL:

- 3.1 ENGAGEMENT/ DISENGAGEMENT FORCE: 0.23 NM MAX
- 3.2 CONTACT RETENTION: 20 N MIN
- 3.3 DURABILITY: 500 CYCLES MIN

4. ENVIRONMENT:

- 4.1 THERMAL SHOCK: MIL-STD-202, METHOD 107, CONDITION B.
- 4.2 OPERATING TEMPERATURE: -55 TO 125°C
- 4.3 SALT SPRAY: MIL-STD-202, METHOD 101, CONDITION B
- 4.4 SHOCK: MIL-STD-202, METHOD 213, CONDITION I
- 4.5 VIBRATION: MIL-STD-202, METHOD 204, CONDITION D
- 4.6 MOISTURE RESISTANCE: MIL-STD-202, METHOD 106

| | | | | |
|--|--|--|--|--|
| | Model No. | 148-0901-721/730 | Johnson | |
| | RoHS2 EU 2011/65/EU | DATE | FILE | ADAPTER ASSEMBLY, JACK TO JACK, 1.85mm |
| <small>FOR THE PURPOSES OF THE ROHS DIRECTIVE, THIS PRODUCT IS CLASSIFIED AS A "REPAIRABLE PRODUCT".</small> | <small>FOR THE PURPOSES OF THE ROHS DIRECTIVE, THIS PRODUCT IS CLASSIFIED AS A "REPAIRABLE PRODUCT".</small> | <small>FOR THE PURPOSES OF THE ROHS DIRECTIVE, THIS PRODUCT IS CLASSIFIED AS A "REPAIRABLE PRODUCT".</small> | <small>FOR THE PURPOSES OF THE ROHS DIRECTIVE, THIS PRODUCT IS CLASSIFIED AS A "REPAIRABLE PRODUCT".</small> | <small>FOR THE PURPOSES OF THE ROHS DIRECTIVE, THIS PRODUCT IS CLASSIFIED AS A "REPAIRABLE PRODUCT".</small> |
| <small>ACCESSIBLE DRAWING IN ACCORDANCE WITH IEC 61340-5</small> | <small>XXXX-02</small> <small>XXXX-01</small> <small>ANGLES-45°</small> | <small>DATE</small> 12/12/2017 | <small>SIZE</small> C | <small>REVISIONS</small> NONE |
| <small>DRAWN BY</small> Betty Yu | | | <small>DRAWING NO.</small> 148-0901-721/730 | <small>REV.</small> 001 |
| <small>DO NOT SCALE</small> | | | <small>DRAWING</small> | <small>SHEET</small> 1 of 1 |